

# taurus

ALPATEC 

## NEW BABEL DIGITAL

Ventilador de torre

Tower fan

Ventilateur de tour

Turmventilator

Ventilatore a torre

Ventilador de torre

Ventilador de torre

Kolomventilator

Wentylator stojący

Ανεμιστήρας πύργος δαπέδου

Věžový ventilátor

Ventilator turn

Вентилятор на стойка

المروحة البرجية

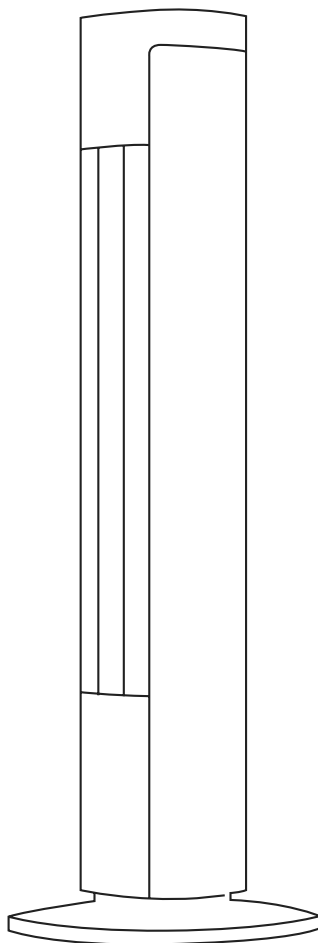

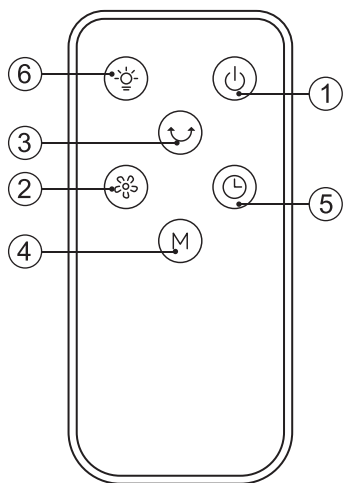
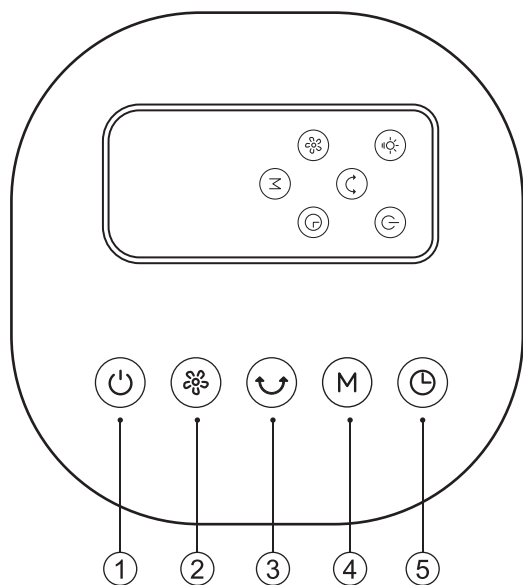
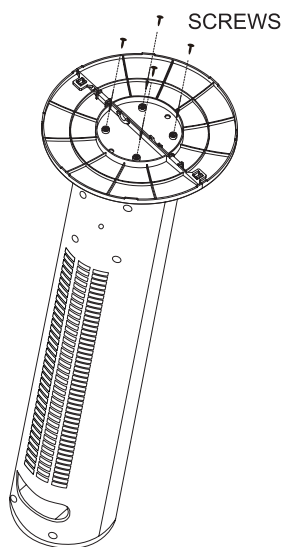
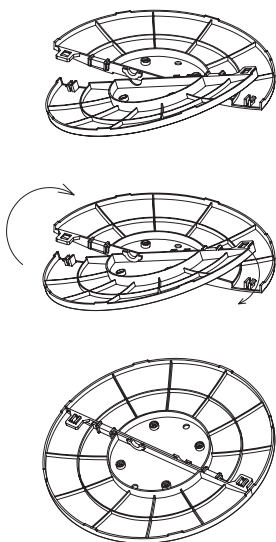

Fig 1



# English

## TOWER FAN

### NEW BABEL DIGITAL

## DESCRIPTION

- 1 On/off
- 2 Speed setting
- 3 Oscillation
- 4 Mode setting
- 5 Timer
- 6 Screen brightness

## USE AND CARE:

- Fully extend the appliance's power cable before each use.
- Do not use the appliance if its accessories are not properly fitted.
- Do not use the appliance if the accessories attached to it are defective. Replace them immediately.
- Do not use the appliance if the on/off switch does not work.
- Do not remove the support feet of the appliance.
- Do not move the appliance while in use.
- Use the appliance handle/s, to catch it or move it.
- Do not use the appliance if it is tipped up and do not turn it over.
- Do not turn the appliance over while it is in use or connected to the mains.
- mains when not in use and before undertaking any cleaning task.
- Store this appliance out of reach of children and/or persons with physical, sensory or reduced mental or lack of experience and knowledge.
- Keep the appliance in a dry, dust-free place, out of direct sunlight.
- Make sure that dust, dirt or other foreign objects do not block the fan grill on the appliance.
- Keep the appliance in good condition. Check that the moving parts are not misaligned or jammed and make sure there are no broken parts or anomalies that may prevent the appliance from operating correctly.
- Never leave the appliance connected and un-

attended if is not in use. This saves energy and prolongs the life of the appliance.

- Do not use the appliance to dry pets or animals.
- Do not use the appliance to dry textiles of any kind.

## INSTALLATION

- Ensure that the fan is switched off from the supply mains before start any installation or assembly operation.
- Do not remove the support feet of the appliance.
- Ensure that the appliance is level with respect to the floor.
- Do not cover or obstruct any of the openings of the appliance.
- The plug must be easily accessible so it can be disconnected in an emergency.
- The appliance should be used with its base fitted.
- The appliance should be used with its base feet fitted.

## ASSEMBLING THE BATTERY/S

- The remote control uses a CR2025 3VDC lithium battery.
- This battery is non-rechargeable. Do not attempt to recharge it.
- Caution: During the handling of batteries, do not touch both poles at the same time, as this will provoke the partial discharge of the stocked energy therefore affecting longevity.
- Caution: The supply terminals are not to be short-circuited.
- Remove the cover of the battery compartment.
- Check that the plastic covering that protects the battery has been removed (some batteries are sold with a protective covering)
- Put the battery in its compartment, respecting the polarity
- Replace the cover of the battery compartment.
- N.B. When changing the batteries, the configuration of the appliance will be removed, and you will need to reset the parameters of the appliance.

## ASSEMBLING THE BASE:

- Fit the base with the column and secure it with the screws provided (Fig.1).

- To fix the base into the appliance, place the appliance face down.
- Fit the base on the main body of the appliance.
- Fix the base using the screws provided.
- Stand the appliance up again so as to check that the base works properly.

## INSTRUCTIONS FOR USE

### BEFORE USE:

- Make sure that all products' packaging has been removed.
- Prepare the appliance according to the function you wish to use:



### USE:

- Extend the cable completely before plugging it in.
- Attach the appliance to its base making sure that it is correctly fitted into place.
- Connect the appliance to the mains.
- Guide the appliance to direct the flow of air in the desired direction.
- Turn the appliance on, by using the on/off button.
- Select the desired speed.

### SCREEN BRIGHTNESS:

- Press (6) button to set LED screen brightness: 100%, 50%, off display (Only handled through remote)

### MODES

- Press mode button (4) to select working mode:
- Normal mode (Display current speed setting F1/F2/F3/SF)
- Nature mode 
- Sleep mode 

### FAN FUNCTION:

- Select the desired ventilation speed.
- F1: Low Speed
- F2: Medium Speed
- F3: High Speed
- SF: Soft Speed

### TIMER FUNCTION:

- To program the operating time simply select it
- Press button 5 to set the timer, the display will show 0h(timer cancel), 1h, 2h...9h, in a continuous cycle.

- After the selected time the appliance will switch off automatically.

### OSCILLATION FUNCTION:

- The oscillation function makes it possible to direct the flow from the apparatus so that it automatically alternates over a range of 75°.
- To activate this function, press the (3) switch.
- To deactivate this function, follow the procedure for switching it on in reverse.

### ONCE YOU HAVE FINISHED USING THE APPLIANCE:

- Turn the appliance off, using the on/off switch.
- Unplug the appliance from the mains.
- Clean the appliance.

### SAFETY THERMAL PROTECTOR:

- The appliance has a safety device, which protects the appliance from overheating.
- If the machine does not start again seek authorised technical assistance.

## CLEANING

- Disconnect the appliance from the mains and allow it to cool before undertaking any cleaning task.
- Clean the equipment with a damp cloth with a few drops of washing-up liquid and then dry.
- Do not use solvents, or products with an acid or base pH such as bleach, or abrasive products, for cleaning the appliance.
- Do not let water or any other liquid get into the air vents to avoid damage to the inner parts of the appliance.
- Never submerge the appliance in water or any other liquid or place it under running water.
- If the appliance is not in good condition of cleanliness, its surface may degrade and inexorably affect the duration of the appliance's useful life and could become unsafe to use.

### HOW TO REMOVE THE BATTERIES FROM THE INTERIOR OF THE DEVICE:

- Remove the cover of the battery compartment.
- Remove the battery.
- Replace the cover of the battery compartment.
- Exhausted batteries are to be removed from the appliance and safely disposed of.
- If the appliance is to be stored unused for a long period, the batteries should be removed.



This symbol means that product may include a battery or batteries; user must to remove them before disposing of the product. Remember that batteries must be disposed of in duly authorised containers. Do not dispose of them in fire.

**taurus**

Avda. Barcelona, s/n  
25790 Oliana  
Spain

Rev. 18/01/22