

hohem iSteadyPro4 Quick Start Guide

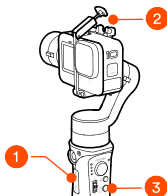

For more tutorial videos please scan YouTube QR code

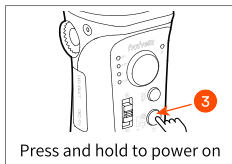
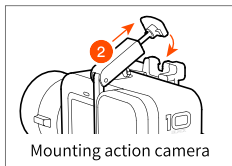
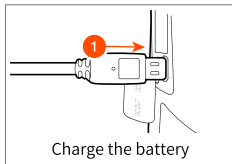

Connect us on Facebook
@HohemTechOfficial

Hohem Gimbal App



CALL CENTER (Toll Free)

UNITED STATES: +1(888)9658512
Mon-Fri: 9:00AM-5:00PM(EST)

UNITED KINGDOM: +44(0)808 2737578
Mon-Fri: 2:00PM-10:00PM(GMT +0)

CANADA: +1(855)758-8939
Mon-Fri: 9:00AM-5:00PM(EST)

BRAZIL: +55 (0)800 5911897
Mon-Fri: 10:00AM-6:00PM(GMT -3)

E-mail: service@hohem.com

iSteadyPro4 How to connect GoPro?

01 | Press and hold the power button for 3 seconds to turn on the gimbal.

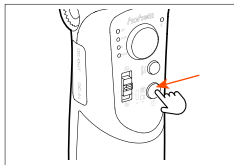

02 | Double-click the PAIR button to enter camera pairing mode and camera connection indicator keeps flashing green.

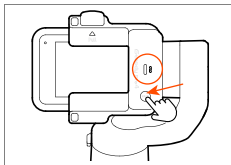

04 | GoPro can be controlled by the gimbal once the camera connection indicator stays on green.

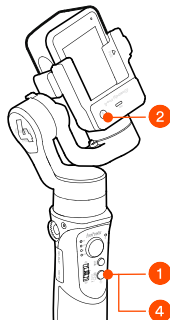
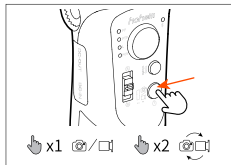

03 | Connect with GoPro (e.g. GoPro 10)

► Unpair the camera: Press and hold the gimbal's PAIR button for 3 seconds, the camera connection indicator will fast flash green 3 times and turn off (if you want to change a camera to connect).

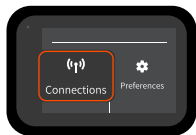

(1) Select 'Connections'

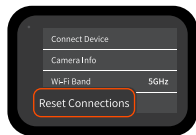

(2) Select 'Reset Connections' - 'Reset'



* (3) Select 'Wireless Connections' - 'On' - 'Connect'



* (4) Select 'GoPro Quik App' and wait for connection

*Wireless connections vary slightly depending on the different GoPro models. E.g. GoPro 5: * (3) Connect New Device -

* (4) Capture App; GoPro 8: * (3) Wireless Connection - * (4) GoPro App.